

RL-0.280

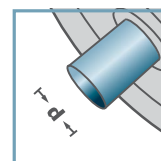

d [mm]
10; 12; 12,8

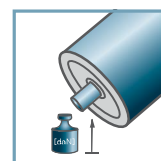

C [daN]
7; 10

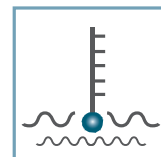

T [°C]
0° - 80°



RL-0.280		
Type	D	B
RL-0.280	28,0	7,6

Des dimensions ultérieures sur demande!

- ☛ Capsule: acier, zinguée
- ☛ Coquille de roulement: acier
- ☛ Boule: acier
- ☛ Anneau de roulement intérieur
 - ☛ Acier: C=10daN
 - ☛ Plastique: C=7daN; 0° - 80°

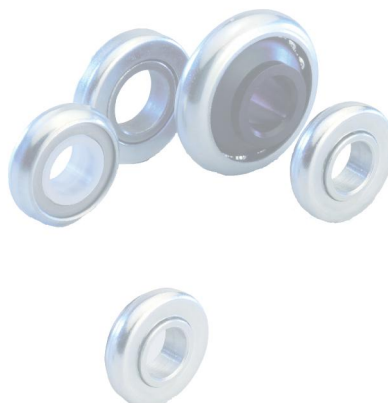

Carton [pc.]

500

Palier annulaire à billes

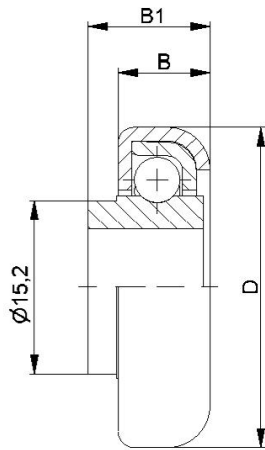

RL-0.280

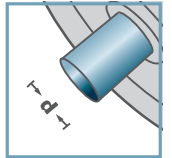

10; 12



C [daN]
7; 10

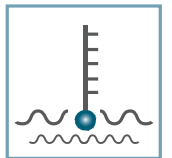

T [°C]
0° - 80°



RL-0.280 typ avec collet			
Type	D	B	B1
RL-0.280 m.B.	28,0	7,6	10,0

Des dimensions ultérieures sur demande!

- ☛ Capsule: acier, zinguée
- ☛ Coquille de roulement: acier
- ☛ Boule: acier
- ☛ Anneau de roulement intérieur
 - ☛ Acier: C=10daN
 - ☛ Plastique: C=7daN; 0° - 80°



Carton [pc.]

500

Palier annulaire à billes

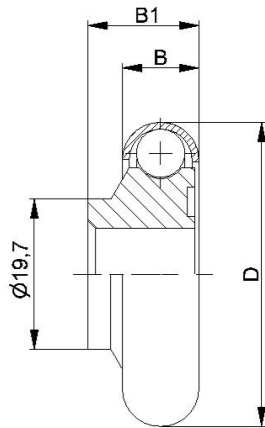

RL-0.400

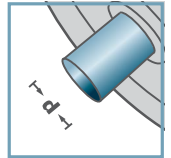

d [mm]
12



C [daN]
7

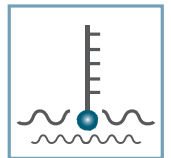

T [°C]
0° - 80°



RL-0.400			
Type	D	B	B1
RL-0.400	40,0	10,0	14,5

Des dimensions ultérieures sur demande!

- ☛ Capsule: acier, zinguée
- ☛ Boule: acier
- ☛ Anneau de roulement intérieur: plastique



Carton [pc.]

250

Palier annulaire à billes

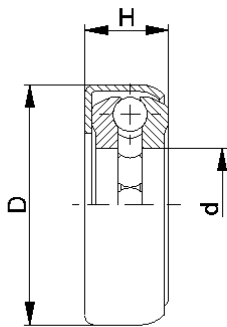

LL-

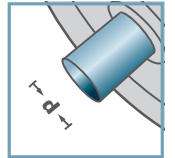

d [mm]
7; 8; 9; 10



C [daN]
20; 22

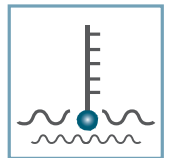



T [°C]
-



-

LL-				
Type	d	D	H	force portante C [daN]
LL-1.073	7,2	15,0	7,0	20
LL-1.082	8,2	15,8	6,85	20
LL-1.083	8,3	17,5	6,2	20
LL-1.093	9,3	17,5	6,2	20
LL-1.103	10,3	17,5	6,2	22

Des dimensions ultérieures sur demande!

-  Capsule: acier
-  Anneau de roulement: acier, trempé
-  Boule: acier

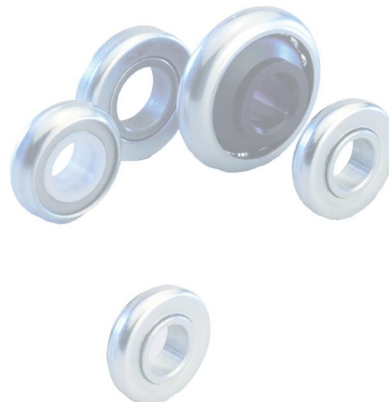

Carton [pc.]

500

Roulement Axial

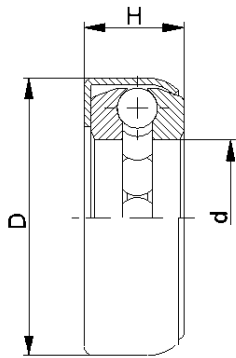

LL-

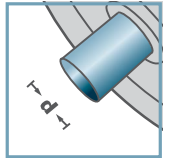

d [mm]
11; 12; 13; 14



C [daN]
22

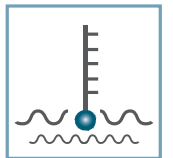

T [°C]
-



-

LL-				
Type	d	D	H	force portante C [daN]
LL-1.113	11,3	20,0	7,0	22
LL-1.123	12,3	22,0	8,0	22
LL-1.133	13,3	22,0	8,0	22
LL-1.141	14,15	22,0	7,7	22

Des dimensions ultérieures sur demande!

- Capsule: acier
- Anneau de roulement: acier, trempé
- Boule: acier



Carton [pc.]

ø11: 500
ø12: 250
ø13: 250
ø14: 250

Roulement Axial

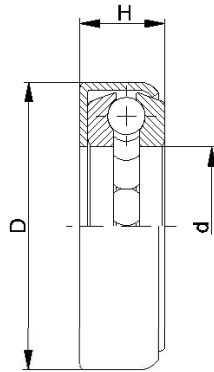

LL-				
Type	d	D	H	force portante C [daN]
LL-1.143	14,3	25,0	8,5	22
LL-1.163	16,4	27,0	9,0	24
LL-1.201	20,1	36,6	10,8	24

Des dimensions ultérieures sur demande!

- ☛ Capsule: acier
- ☛ Anneau de roulement: acier, trempé
- ☛ Boule: acier



LL-

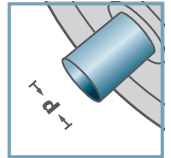

d [mm]
14; 16; 20



C [daN]
22; 24

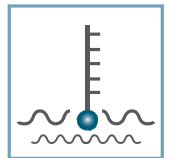

T [°C]
-



Carton [pc.]

ø14: 200
ø16: 200
ø20: 350

Roulement Axial

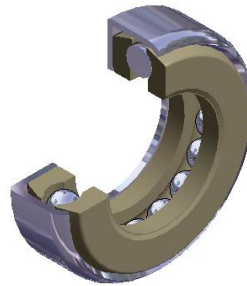
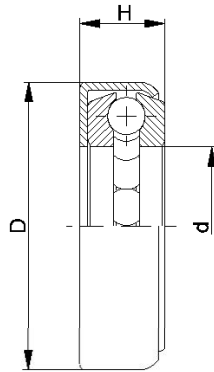

LL-

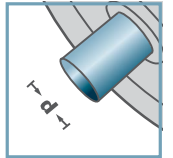

d [mm]
20; 22; 23;
24; 25; 26



C [daN]
26

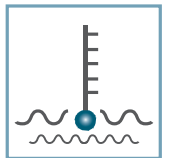



T [°C]
-



LL-				
Type	d	D	H	force portante C [daN]
LL-1.203	20,4	33,0	10,0	26
LL-1.223	22,4	43,5	12,0	26
LL-1.233	23,4	43,5	12,0	26
LL-1.243	24,4	43,5	12,0	26
LL-1.253	25,4	43,5	12,0	26
LL-1.263	26,4	43,5	12,0	26

Des dimensions ultérieures sur demande!

-  Capsule: acier
-  Anneau de roulement: acier, trempé
-  Boule: acier

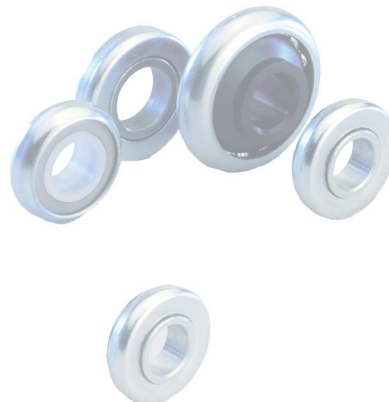

Carton [pc.]

ø20:	100
ø22:	50
ø23:	50
ø24:	50
ø25:	50
ø26:	50

Roulement Axial